

FEATURES

- Can Fit Through a Standard 36" Door
- High efficiency burners and all service components are front mounted for easy access.
- Removable hood
- Stone hearth decks
- Individual steam controls for each deck
- Halogen lamps on each deck
- Available in Natural gas or LP

BEcom's MSTO Series Oven has genuine vapor tube technology for the most authentic brick oven baking. The oven's individual self-contained steam system, with the help of new atmosphere burners, saves up to 50% of energy usage. The high efficiency burners, and all other components, are front mounted for easy access. These ovens have stone decks for that perfect artisan stone baked bread. The Mini steam tube oven is fully equipped with a removable hood, halogen lamps on each deck, and full glass doors for an easy view of your product.

BEcom Mini Steam Tube Oven



BE-MSTO SERIES

BECOM SALES.COM, INC.

Main Warehouse

409 W. Cooper Street, Tipton MO 65081

Corporate Headquarters

5500 Olympic Drive
STE H105 - PMB 117, Gig Harbor, WA 98335

Customer Service

PH: 360-255-7467, 888-869-5737
FX: 253-276-0244 sales@becomsales.com

MODEL	SQ. FT.	PAN SIZE	PAN QTY	DIMENSIONS W/OUT HOOD D x W x H	DIMENSIONS W/ HOOD D x W x H	DECK DIMENSIONS D x W x H	ELECTRIC POWER	HEATING POWER	WEIGHT
BE-MSTO 20	25	18" x 26"	8	35" x 59" x 83"	35" x 59" x 83"	27" x 40" x 6"	120V - 1Ph 60Hz - 20 AMPS	95.000 BTUs	2800 lbs.
BE-MSTO 40	43	18" x 26"	12	35" x 85" x 83"	48" x 85" x 83"	27" x 59" x 6"	120V - 1Ph 60Hz - 20 AMPS	135.000 BTUs	3000 lbs.

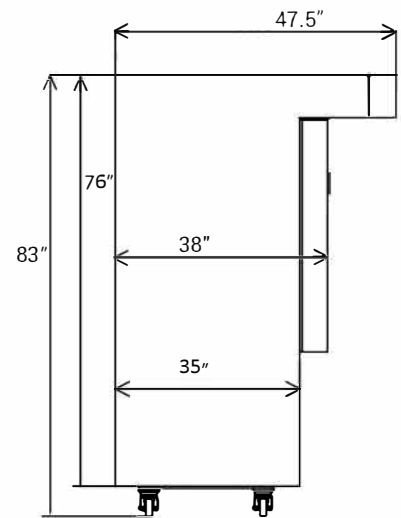
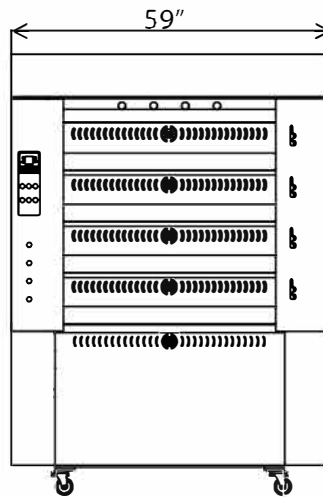
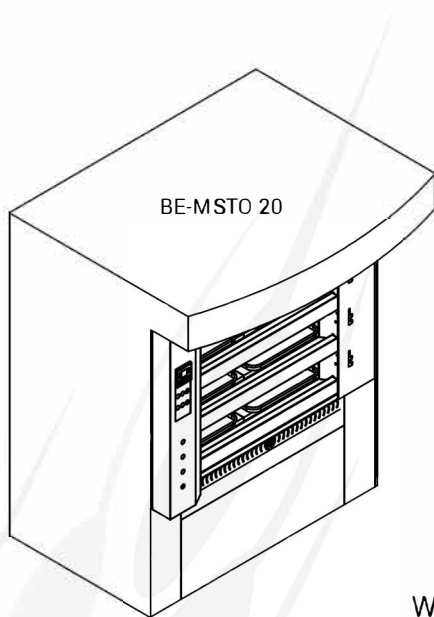

Water Pipe Connection: 3/4"
 Drain Of Steam Generator: 3/4"
 Gas Pipe Connection: 3/4"

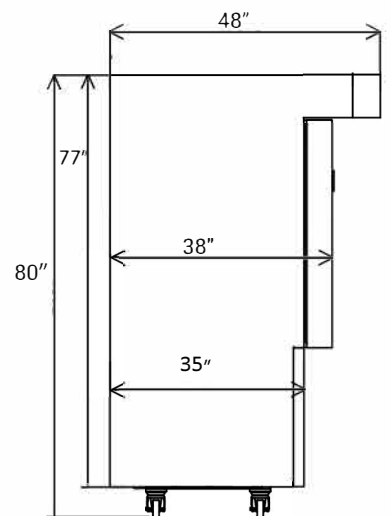
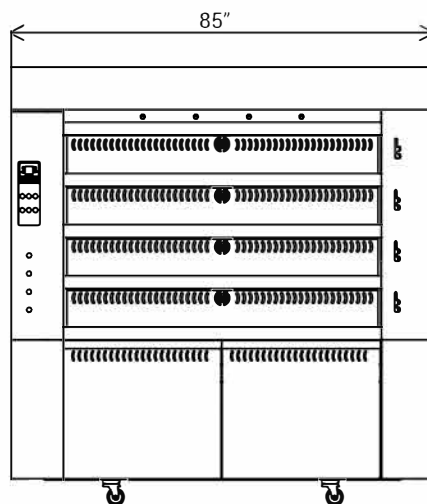
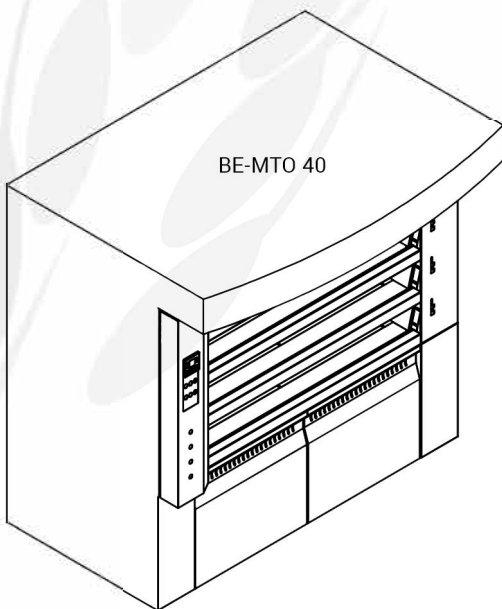

BECOM SALES.COM, INC.

Main Warehouse

409 W. Cooper Street, Tipton MO 65081

Corporate Headquarters

5500 Olympic Drive
 STE H105 - PMB 117, Gig Harbor, WA 98335

Customer Service

PH: 360-255-7467, 888-869-5737
 FX: 253-276-0244 sales@becomsales.com